

# BenQ InstaShowS™ WDC20

## Plug and play for wireless 4K presentations

### InstaShowS™ WDC20 Features

- True Plug & Play
- No Software on NB
- Wireless 802.11ac/n
- 4 Split Screen
- Auto Channel Selection
- Video and Audio Support
- Assured Performance
- Extended Desktop
- Mobile Projection (iOS/Android)
- 32 maximum presenters per hub
- Touch back



### Setup

Step 1. Connect cable

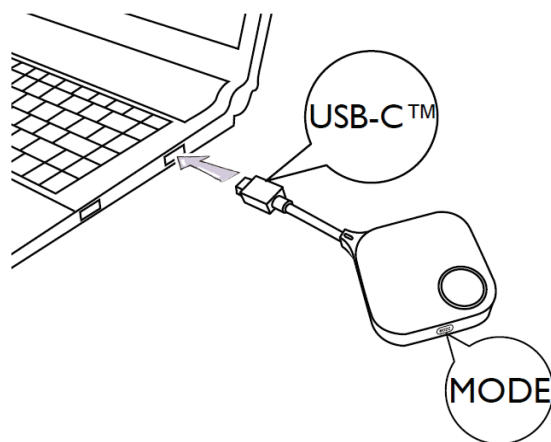

Step 2. Push the button when LED is green

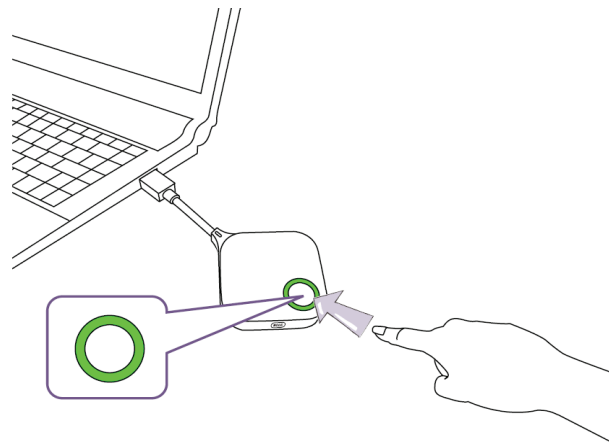

SPECIFICATIONS		InstaShowS™ WDC20		
FEATURES	Model name	WDC20		
	Product name	InstaShow™ S Button kit		
	Color	Black		
	Video outputs	HDMI 1.4, comply with HDCP		
	Frame Rate	Up to 60 fps depending on environment (FHD)		
	Output resolution	720x480, 720x576, 1280x720, 1920x1080 (1080p), up to 3840x2160(30Hz)		
	Input resolution	Video:480p, 576p, 720p, 1080p PC timing: 640x480, 800x600, 1024x768, 1280x720, 1920x1080		
	Simultaneous connections	32 pcs		
	Audio	Stereo, Radio quality 16bits 48KHz		
	Wireless	IEEE 802.11ac, 5GHz, 2T2R IEEE 802.11n, 2.4GHz, 2T2R		
	Data rate wireless	Up to 867 + 300Mbps		
	Authentication protocol	WPA2 (WPA2-PSK (Pre-Shared key) / WPA2-Enterprise)		
	Security (encryption)	WPA2 Personal (AES 128 bit)		
	Support platform	Windows, MAC, Chrome. Any OS supports HDMI standard 1.4		
	Reach	Max. 15m between InstaShow S Button and InstaShow S Host		
	Temperature range	Storage: -10°C to +60°C (+14°F to +140°F) Operating: 0°C to +40°C (+32°F to +104°F)		
Humidity	Storage: 5% to 90% relative humidity, non-condensing Operation: 10% to 80% relative humidity, non-condensing			
INSTASHOW BUTTON	Cable	USB Type A, HDMI Cable	Power Supply	DC 5V±10%, 0.5A
	Reset Button	x1	Power Consumption	2.5W
	Mode Key	NA	Dimension (WxHxD)	67x67x24.2mm (without wire) 81x291x24.2mm (with wire)
	LED	3/6 LED(R.G.B)	Weight	81g
CRADLE	Dimension	100.4x92.6x152mm	Weight	550g
PACKAGE	InstaShow Button	x2	Velcro Strap	No
	InstaShow Host	No	Quick Start Guide	x1
	Cradle	x1	Safety Statement	x1
	HDMI Cable	x1	Double-side Sponge Tap	No
	USB Extended Cable	No	Rubber Feet	No
	Antenna	x4 (Black)	Screws	No
	Adapter	x1		

\* Please find detail LED behavior in the user manual.

\*\*Wireless connection speed is depended on wireless environment.